

WARNING

•Missing or altered serial numbers automatically void the warranty. For your own protection, be sure the serial number labels on the unit and exterior box are intact.



Note: This equipment has been tested and found to comply with the limits for a Class B digital device, pursuant to part 15 of the FCC Rules. These limits are designed to provide reasonable protection against harmful interference in a residential installation. This equipment generates, uses and can radiate radio frequency energy and, if not installed and used in accordance with the instructions, may cause harmful interference to radio communications. However, there is no guarantee that interference will not occur in a particular installation. If this equipment does cause harmful interference to radio or television reception, which can be determined by turning the equipment off and on, the user is encouraged to try to correct the interference by one or more of the following measures:

- Reorient or relocate the receiving antenna.
- Increase the separation between the equipment and receiver.
- Connect the equipment into an outlet on a circuit different from that to which the receiver is connected.
- Consult the dealer or an experienced radio/TV technician for help.

ONE-YEAR LIMITED WARRANTY

Tech 21 warrants unit to be free from defects in materials and workmanship for a period of one (1) year from the date of purchase to the original purchaser and is not transferable. This warranty does not include damage resulting from accident, misuse, abuse, alteration, or incorrect current or voltage. If unit becomes defective within warranty period, Tech 21 will elect to repair or replace it free of charge. After warranty period expires, manufacturer will repair defective unit for a fee.

PROOF OF PURCHASE IS REQUIRED FOR ALL REPAIRS

Residents of the U.S. and Canada: Contact Tech 21 for a Return Authorization Number and shipping instructions. Tech 21 will not accept packages without prior authorization, pre-paid freight (UPS preferred), and proper insurance.

Residents of the EU: Contact Sound Service GmbH

T: +49 (0)33708 933-0 / E: service@sound-service.eu / W: www.sound-service.eu

FOR PERSONAL ASSISTANCE & INQUIRIES

Contact Tech 21 weekdays from 9:00 AM to 5:00 PM, Eastern Standard Time

T: 973-777-6996 / E: info@tech21nyc.com / W: www.tech21nyc.com

Contact Sound Service weekdays from 9:00 to 17:00, Central European Time.

T: +49 (0)33708 933-0 / E: info@sound-service.eu / W: www.sound-service.eu



T: 973-777-6996

E: info@tech21nyc.com

W: www.tech21nyc.com

© 2018 Tech 21 USA, Inc.



MADE IN KOREA

All electrical and electronic products should be disposed of separately from the municipal waste stream via designated collection facilities appointed by the government or the local authorities

(Rev 09.19)

POWER ENGINE DEUCE DELUXE



Owner's Manual

IMPORTANT SAFETY INSTRUCTIONS. READ AND SAVE THESE INSTRUCTIONS. HEED ALL WARNINGS.



This symbol, wherever it appears, alerts the user to the presence of uninsulated dangerous voltage within the product's enclosure that may be of sufficient magnitude to constitute a risk of electric shock to persons.



This symbol, wherever it appears, alerts the user to important operating and maintenance instructions in the accompanying literature. Read the manual.

This unit is powered by potentially hazardous voltage. Therefore, observe the following safety precautions:



1. Read and follow all instructions before using product.
2. Do not use product near water (such as near a bathtub, washbowl, kitchen sink, swimming pool, in a wet basement, etc.).
3. Unit should be located so that its location or position does not impede the flow of air through the ventilation openings.
4. Product should be located away from heat sources such as radiators, heat registers, or other products, including amplifiers, that produce heat.
5. Product should be connected to a power supply only of the type described in the operating instructions or as marked on the product.
6. Protect the power cord from being walked

on or pinched, particularly at plugs, convenience receptacles, and the point where they exit from the unit.

7. Do not allow objects or liquids to penetrate the enclosure through openings.
8. During heavy use, chassis may get hot to the touch. Handle with care.
9. Protect unit from strong impact.
10. Unplug product before cleaning. Never spray liquid cleaners into the amp: wipe with a clean, lint-free cloth to remove dirt and film.
11. Only use attachments/accessories specified by the manufacturer.
12. This product should be used only with a cart or stand that is recommended by the manufacturer. When a cart is used, use caution when moving the cart/product combination to avoid injury from tipping over.
13. Amplifiers may be capable of producing high volume levels that could cause permanent hearing loss or damage, if the exposure to such levels is prolonged. Such damage is progressive and irreversible! If you experience any hearing loss or ringing in the ears, consult an audiologist.



14. Unplug unit during lightning storms or when unused for long periods of time.

15. This unit must be earth grounded. To reduce risk of electric shock, NEVER remove or attempt to defeat the ground pin of the power cord. If the provided plug does not fit into your outlet, consult an electrician for replacement of the obsolete outlet.

WARNING: To avoid the risk of fire, electric shock or injury, do not expose this unit to rain or moisture. Do not remove the chassis from its cabinet, or remove metal covering from chassis parts. Removing the chassis from its cabinet exposes extremely dangerous high voltages. There are no user-serviceable parts inside. Hazardous voltages are present inside the chassis. Refer all servicing to qualified personnel.

CAUTION: Never modify the power cord. If original power cord becomes damaged, frayed, or has exposed wires, replace immediately with same rating and gauge, or higher. Replacements are commercially available or you can contact Tech 21 directly.

WARNING: There are no user-serviceable parts inside. Attempting to repair this unit is not recommended and may void its warranty. Refer all servicing to qualified personnel. NOTE: In the U.S. and Canada, servicing is performed at factory only. In other countries, please refer repairs to the local Tech 21 authorized distributor.

FUSE



Fuse holder is located inside A/C cord receptacle. **You must disconnect and remove power cord to change fuse.** Replace with similar type and same value:
100V - 240V units use F 3.15A L

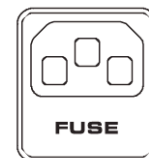

QUICK START AND STOP INSTRUCTIONS

Here's how you can get your Power Engine Deuce Deluxe up and running before you read the entire manual. Note: By not reading the manual, you'll miss out on how to get the most out of your new investment!

1. Before turning on any power or connecting any devices, be sure all volume controls are at minimum.
2. Connect devices using appropriate inputs and outputs.
3. Turn on the preamp/processor first. Then turn on the Power Engine.
4. Slowly bring up the volume controls, alternating between devices as you go, until desired volume is achieved. If you don't hear your instrument, check its volume control.
5. If there's still no sound, recheck your connections and be sure your cable isn't faulty. Otherwise, refer to factory or qualified technician.

QUICK STOP: After shutting off the Power Engine Deuce Deluxe (or any amplifier), wait at least 10 seconds before turning it back on.

DEUTSCH: Wichtige Informationen zur Sicherheit!
LESEN SIE DIE FOLGENDEN INFORMATIONEN SORGFÄLTIG DURCH.
BEWAHREN SIE ALLE ANLEITUNGEN FÜR DIE ZUKÜNFTIGE
BEZUGNAHME AUF

- **Befolgen Sie alle auf dem Produkt ausgewiesenen Warnungen und Anleitungen!**
- **Gefahr! Hohe interne Betriebsspannungen**
- Öffnen Sie nicht das Gehäuse des Geräts. Es befinden sich keine vom Anwender zu wartende Teile in diesem Gerät. Überlassen Sie alle Servicearbeiten qualifiziertem Wartungspersonal.
- Nur mit einem trockenen Lappen reinigen
- Auf der Innenseite eines Verstärkers kann sich Kondensationsnässe bilden, wenn er von einer kalten Umgebung an einen wärmeren Ort bewegt wird. Es wird empfohlen, dass das Gerät vor dem Einschalten Zimmertemperatur erreicht.
- Unerlaubte Änderungen an diesem Gerät sind ausdrücklich von Tech 21 verboten.
- Stecken Sie niemals Objekte jeglicher Art in die Lüftungsschlitze des Gehäuses.
- Setzen Sie dieses Gerät nicht Regen, Flüssigkeiten oder Feuchtigkeit jeglicher Art aus.
- Platzieren Sie dieses Produkt nicht auf einem instabilen Rollwagen, Ständer oder Tisch. Das Produkt kann herunterfallen und dem Produkt oder Personen ernsthaften Schaden zufügen!
- Blockieren oder verdecken Sie nicht die Lüftungsschlitze oder -öffnungen.
- Bitte benutzen Sie das Gerät nur in gut belüfteten Räumen und schalten Sie es nie in schlecht belüfteten Umgebungen, wie z.B. Schränken o.ä. an.
- Dieses Produkt sollte nicht in der Nähe einer Wärmequelle wie einem Ofen, Heizkörper oder einem anderen Hitze entwickelnden Verstärker platziert werden.
- Verwenden Sie nur das zum Lieferumfang gehörende Netzkabel, das mit der Netzstromversorgung in Ihrer Region kompatibel ist.
- Netzkabel müssen stets mit Vorsicht gehandhabt und ersetzt werden, wenn sie in irgendeiner Weise beschädigt werden.
- Brechen Sie niemals den Erdungsstift (Erde) am Netzkabel ab.
- Das Netzkabel sollte aus der Steckdose gezogen werden, wenn das Gerät längere Zeit nicht verwendet wird.
- Bevor das Gerät eingeschaltet wird, muss der Lautsprecher entsprechend der Beschreibung im Handbuch unter Verwendung des vom Hersteller empfohlenen Kabels angeschlossen werden.
- Ersetzen Sie beschädigte Sicherungen stets mit der korrekten Spannung und Art.
- Trennen Sie niemals die schützende Netz/Erde-Verbindung
- Hohe Lautsprecherpegel können permanente Hörschäden verursachen. Sie sollten daher die direkte Nähe zu Lautsprechern, die auf hohen Pegeln betrieben werden, vermeiden. Tragen Sie einen Hörschutz, wenn Sie kontinuierlich hohen Pegeln ausgesetzt sind.
- Wenn das Produkt nicht normal funktioniert, während die Betriebsanleitung befolgt wird, übergeben Sie das Produkt an einen qualifizierten Servicetechniker.

Français: Consignes de sécurité importantes !
LISEZ LES INFORMATIONS SUIVANTES ATTENTIVEMENT. CON-
SERVEZ TOUTES LES CONSIGNES POUR RÉFÉRENCE ULTÉRIEURE !

- **Respectez tous les avertissements et toutes les consignes figurant sur le produit !**
- **Danger ! Hautes tensions internes.**
- N'ouvrez pas le boîtier de l'appareil. Cet appareil ne possède aucune pièce sur laquelle l'utilisateur puisse intervenir. Confiez toutes les réparations à un réparateur qualifié.
- Nettoyez l'appareil avec un chiffon sec uniquement.
- Il est possible que de la condensation se forme à l'intérieur d'un amplificateur s'il est transféré d'un environnement froid à un endroit plus chaud. Il est conseillé d'attendre que l'appareil ait atteint la température ambiante avant de l'allumer.
- La modification non autorisée de cet appareil est expressément interdite par Tech 21.
- N'introduisez jamais d'objets dans les fentes de ventilation du boîtier de l'appareil.
- N'exposez pas cet appareil à la pluie, à des liquides ni à aucune forme d'humidité.
- Ne placez pas ce produit sur un chariot, un guéridon ou une table instable. Il pourrait tomber et ce faisant sérieusement s'endommager ou causer des blessures !
- Ne couvrez pas les fentes de ventilation ni les ouvertures et ne les obstruez pas non plus.
- Cet appareil doit être utilisé dans un environnement bien ventilé et ne doit jamais être mis sous tension si l'endroit est confiné.
- Évitez de placer ce produit près d'une source de chaleur telle qu'un poêle, un radiateur ou un autre amplificateur produisant de la chaleur.
- Utilisez uniquement le cordon d'alimentation fourni car il est compatible avec la tension de l'alimentation générale de votre secteur.
- Manipulez toujours les cordons d'alimentation avec le plus grand soin. Remplacez-les s'ils sont endommagés.
- Ne détachez jamais la prise de terre du cordon d'alimentation.
- Débranchez le cordon d'alimentation en cas d'inutilisation prolongée de l'appareil.
- Avant d'allumer l'appareil, branchez l'enceinte de la manière décrite dans la notice d'emploi à l'aide du cordon recommandé par le fabricant.
- Remplacez toujours les fusibles endommagés par des fusibles du type et du calibre appropriés.
- Ne débranchez jamais la connexion à la terre de protection.
- À des niveaux élevés, le volume des enceintes peut causer des pertes auditives définitives. Par conséquent, évitez de rester à proximité des enceintes lorsque le volume est élevé. Portez des protecteurs d'oreilles en cas d'exposition continue à des niveaux sonores élevés.
- Si le produit ne fonctionne pas normalement alors que vous respectez la notice d'emploi, confiez-le à un réparateur qualifié.

**Español: ¡AVISO! Importante Información de seguridad.
LEA LA SIGUIENTE INFORMACIÓN DETENIDAMENTE Y CONSERVE
LAS INSTRUCCIONES PARA FUTURAS CONSULTAS.**

- **SIGA TODOS LOS AVISOS E INSTRUCCIONES MARCADAS EN LOS PRODUCTOS.**
- **¡PELIGRO! Alto voltaje interno.**
- NO ABRA LA TAPA DEL EQUIPO. NO HAY PARTES UTILIZABLES PARA OTROS FINES EN ESTE EQUIPO. REMITA CUALQUIER ANOMALÍA AL SERVICIO TÉCNICO CUALIFICADO.
- UTILICE TRAPOS SECOS PARA SU LIMPIEZA.
- SE PUEDE FORMAR CONDENSACIÓN DENTRO DEL AMPLIFICADOR SI ESTE SE HA MOVIDO DE UN LUGAR FRÍO A OTRO MÁS CALIDO. EN EL CASO DE QUE SE MOVIERA EL AMPLIFICADOR DE UN SITIO MÁS FRÍO A OTRO MÁS CALIDO O A LA INVERSA, DEJE UN RATO EL AMPLIFICADOR SIN ENCENDER PARA QUE ESTE ALCANCE LA TEMPERATURA MEDIA DEL NUEVO LUGAR.
- LAS MODIFICACIONES NO AUTORIZADAS ESTÁN EXPRESAMENTE PROHIBIDAS POR TECH 21.
- NUNCA APOYE OBJETOS EN NINGUNO DE LOS AGUJEROS DE VENTILACIÓN LOCALIZADOS EN LAS TAPAS DEL EQUIPO.
- NO EXPONGA LOS EQUIPOS A LA LLUVIA, LIQUIDOS O HUMEDAD DE CUALQUIER TIPO.
- SIGA TODOS LOS AVISOS E INSTRUCCIONES MARCADAS EN EL PRODUCTO.
- NO PONGA LOS EQUIPOS EN CARRETILLAS O MESAS INESTABLES. EL EQUIPO PUEDE CAER DAÑÁNDOSE SERIAMENTE, ASÍ COMO A OTRAS PERSONAS.
- NO CUBRA O BLOQUEE LOS AGUJEROS DE APERTURA Y VENTILACIÓN.
- ESTE EQUIPO SE DEBERÁ USAR EN UN LUGAR BIEN VENTILADO Y NUNCA SE DEBERÁ ENCENDER EN ESPACIOS POCO VENTILADOS, COMO UNA ESTANTERÍA.
- ESTE PRODUCTO NO DEBE SER PUESTO CERCA DE UNA FUENTE DE CALOR COMO PUEDE SER UN RADIADOR, ESTUFA O CUALQUIER PRODUCTOR O AMPLIFICADOR DE CALOR.
- USE SÓLO LA FUENTE DE ALIMENTACIÓN QUE SEA COMPATIBLE CON LOS VOLTAJES UTILIZADOS EN EL ÁREA EN DONDE ESTÉ.
- LA FUENTE DE ALIMENTACIÓN DEBE DE SER MANEJADA CON CUIDADO Y DEBE DE SER REMPLAZADA EN CASO DE CUALQUIER DAÑO.
- NUNCA ROMPA LA TOMA DE TIERRA SOBRE EL CABLE DE CORRIENTE.
- EL CABLE DE CORRIENTE DEBERÁ DE SER DESCONECTADO CUANDO LA UNIDAD NO VAYA A SER USADA DURANTE UN TIEMPO.
- ANTES DE ENCENDER UN CABEZAL, LA PANTALLA DEBERA ESTAR CONECTADA COMO SE DESCRIBE EN EL LIBRO DE INSTRUCCIONES UTILIZANDO LOS CONDUCTORES RECOMENDADOS POR EL FABRICANTE.

- REEMPLAZA SIEMPRE LOS FUSIBLES DAÑADOS POR OTROS DE CARACTERÍSTICAS IDÉNTICAS.
- NUNCA DESCONECTE EL PROTECTOR DE LA TOMA DE TIERRA.
- LA POTENCIA DE SONIDO DE LOS ALTAVOCES CUANDO LOS NIVELES SON ALTOS PUEDE CAUSAR DAÑO PERMANENTE. SE DEBE EVITAR POR TANTO LA EXPOSICIÓN DIRECTA A LOS ALTAVOCES CUANDO ESTOS ESTÉN OPERANDO A UN NIVEL ALTO. USA SIEMPRE PROTECTORES AUDITIVOS ANTE UNA EXPOSICIÓN PROLONGADA.
- SI EL PRODUCTO NO FUNCIONARA UNA VEZ SEGUIDAS TODAS LAS INSTRUCCIONES, REMÍTALO A UN SERVICIO TÉCNICO CUALIFICADO.

Tech 21, the Company

Tech 21 was formed by a guitarist possessing the unusual combination of a trained ear and electronics expertise. In 1989, B. Andrew Barta incorporated Tech 21 and made his unique invention commercially available to players and studios around the world. His highly-acclaimed **SansAmp™** pioneered Tube Amplifier Emulation in professional applications for recording direct and performing live, and created an entirely new category of signal processing. While there have since been many entries into this niche, SansAmp continues to maintain its reputation as the industry standard.

With a full line of SansAmp models, Tech 21 also offers effect pedals and MIDI products, as well as “traditional” style amplifiers for guitar and bass. Each product is thoughtfully and respectfully designed by Andrew himself with the player in mind. Our goal is to provide you with flexible, versatile tools to cultivate, control, refine and redefine your own individual sound. Tech 21 takes great pride in delivering consistent professional quality sound, studio to studio, club to club, arena to arena.

Power Engine Deuce Deluxe, an Overview

The Power Engine Deuce Deluxe is a pumped up version of our former Power Engine 60 and can be used for both guitar and bass. This handsome 1x12 rear-ported cabinet is capable of delivering 200 watts of **transparent** power with convenient, on-board 3-band, active EQ controls to compensate for challenging venues. Other new features include low and high pass filters, defeatable tweeter, an extension speaker output, headphone output, auxiliary input, and worldwide power supply.

You can use the Power Engine Deuce Deluxe with any direct recording device or pre-amp --analog or digital, tube or solid state-- from any manufacturer. (Of course, we happen to be partial to our own line of pre-amps, but that's just us.) So you can take your Fly Rig/SansAmp or preamp gizmo du jour, with all those great direct sounds you've spent so much time creating, out to a gig and simply plug into the Power Engine Deuce Deluxe. It will amplify all your personal settings without giving you any additional coloration. Just volume, no tone.

You can also incorporate the Power Engine Deuce Deluxe into your existing rig to substantially increase the volume when you need it for larger venues, as well as for monitoring.

FRONT PANEL

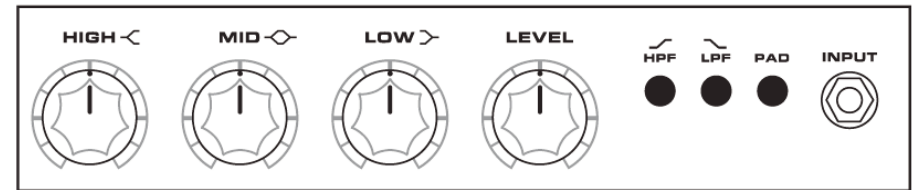

1/4" INPUT

High impedance 1 megOhm for instruments and/or processors.



NOTE: DO NOT PLUG THE SPEAKER OUTPUT OF ANY AMP INTO THIS INPUT. Doing so may result in severe damage to the unit or your amp or both.

PAD SWITCH

Allows you to connect equipment with a variety of signal levels to the Power Engine:

-10dB (out position): Instrument level input.

0dB (in position): Line-level input.

NOTE: Pad switch affects both the 1/4" input as well as the rear panel XLR input.

AUX INPUT

Studio-grade 1/4" auxiliary input for audio devices such as CD/mp3 players. It accepts stereo signal and sums to mono.

NOTE: This input is not controlled by the Power Engine.

Volume and tone adjustments should be made via the audio device.

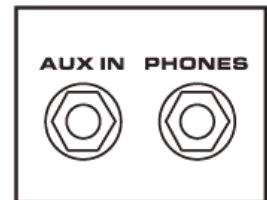

PHONES

Studio-grade 1/4" headphone mono output. Mutes the power amp. NOTE: For best results, we recommend using headphones rated at 32Ω. Otherwise, performance may be compromised by efficiency loss. Also be sure the Level control is turned down to reduce the risk of hearing damage.

GUIDE TO CONTROLS

The Power Engine Deuce Deluxe is designed with active EQ controls, which boost and cut, rather than traditional passive controls which only cut. This effectively doubles many of the controls' capabilities, giving you a much larger range of adjustability and, ultimately, more variety. It should be noted that you need not necessarily set everything at max to achieve maximum results.

LOW, HIGH

Active shelving EQ controls. Low and High cut or boost $\pm 12\text{dB}$ from unity gain (12 o'clock), with pivot point at 1kHz.

MID

Active EQ, cut or boost $\pm 12\text{dB}$ from unity gain (12 o'clock), centered at 1kHz.

HPF

High Pass Filter. Filters out rumble and low frequency artifacts of certain instruments or vocal mics that emit unintelligible rumble. Engaged (in position), frequencies below 100 Hz are attenuated at 12dB per octave. Refer to Noteworthy Notes for tips.

LPF

Low Pass Filter. Engaged (in position), frequencies above 3 kHz are attenuated at 12dB per octave. Refer to Noteworthy Notes for tips.

LEVEL

Adjusts the volume level of the Power Engine Deuce Deluxe.

REAR PANEL

XLR IN

Balanced XLR input accepts XLR output of your pre-amp/processor or amplifier.

NOTE: This input is not intended to be used with a mic, as it will not provide sufficient level.

REMINDER: The pad switch on the front panel affects both the 1/4" input as well as the XLR input.

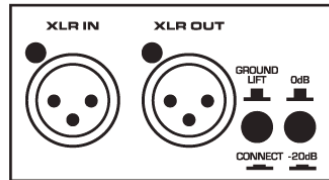

XLR OUT

Balanced low impedance XLR parallel output is connected directly to the input, so that the signal bypasses the tone controls. For live gigs, you can use this output directly into the P.A. system so you won't need to mic the Power Engine.

XLR LEVEL SWITCH

Allows you to connect the Power Engine via the XLR Output to other equipment with different input level requirements:

0dB (out position): Line-level output.

-20dB (in position): Pads down the line-level signal by 20dB.

GROUND LIFT

Connects or disconnects the ground circuits between the XLR Output of the Power Engine and the mixer. We recommend starting with the ground lifted. If necessary, connect the ground by pushing the button in.

EXTENSION SPEAKER OUTPUT

1/4" connector for an external speaker cabinet, 8-Ohm minimum, 100 Watts. It is wired in parallel and therefore will not defeat the internal speaker.

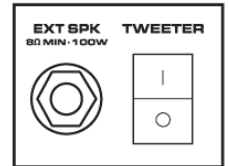

TWEETER ON/OFF SWITCH

The tweeter extends the high frequency capability of the Power Engine Deuce Deluxe. Simply turn on and off as desired.



FUSE

Replace with similar type and same value:
100V - 240V units use F 3.15A L



IMPORTANT REMINDER:

Fuse holder located inside A/C cord receptacle. **You must disconnect and remove power cord to change fuse.**



WORLDWIDE POWER

The Power Engine automatically detects the electrical source and can be operated on voltages ranging from 100-240V AC, 50/60 Hz.



OVERHEATING

In the event of overheating, there is a heat protection circuit which will automatically shut down the unit. Normal operation will resume when the heat dissipates.

NOTE: Direct sunlight may contribute to overheating.

NOTE: Be sure there is ventilation on all sides and the vent openings on the back are not obstructed to restrict the flow of air to the heatsinks.

NOTEWORTHY NOTES & CONSIDERATIONS

1) Powering Up and Powering Down. To avoid the typical loud pop and potential harm to the speaker and/or horn, power up in this order:

For mono applications:

- 1st:** Amplifier or pre-amp/processor
- 2nd:** Power Engine Deuce Deluxe

For stereo applications:

- 1st:** Stereo processor
- 2nd:** Amplifier or pre-amp/processor
- 3rd:** Power Engine Deuce Deluxe

2) EQ. We recommend starting with all controls flat. Then use each sparingly as needed for whatever room you're in. Remember, you need not set everything at max to obtain maximum results. It would be rare that turning all the tone controls up would accomplish a favorable sound. In most instances, a slight cut of the Mid control should be adequate.

3) HPF/LPF Tips. The LPF and HPF provide expanded flexibility so the Power Engine can be used with a variety of instruments with different attributes. For example, if you are amplifying an electric guitar, engage both filters to simulate the response of a guitar cabinet. For bass, engaging the LPF only will simulate the sound of a vintage cabinet. Acoustic guitars will benefit from more high-end response, so disengage the LPF and engage the HPF to remove boominess. For full range instruments such as keyboards, disengage both filters.

4) Clipping. Be aware the Power Engine Deuce Deluxe is not designed for use with a guitar or bass plugged directly into it, as it may cause the tweeter to clip, especially at higher volume. For optimal operation and maximum headroom, an amp emulating preamp provides compression to smooth out signal spikes.

POWER ENGINE DEUCE DELUXE SPECIFICATIONS

Note: With on-going product development and improvements, specifications and/or the cosmetic appearance of this unit may change without prior notice.

Replacement parts are available, i.e., knobs, logo plate, handles, etc. For more information, please contact your authorized dealer or Tech 21.

Model Number:	PE-200
1/4" Input Impedance:	1M Ω
XLR Input Impedance:	10k Ω
Nominal Input Level:	150mV / 500mV with Pad
Minimum Load Impedance:	4 Ohms total
Maximum Power Output:	200 Watts RMS @ 4 Ohms (total minimum load)
Aux In Impedance:	10k Ω
Phones Input Impedance:	32 Ohms
XLR Output Level (selectable):	0dB through output (buffered from input) to -20dB
Maximum Power Consumption:	approx. 280VA
AC Input Power:	100-240 VAC
Cycles:	50/60 Hz
Speaker:	200W - 8 Ohms 12-inch stamped-frame speaker
Tweeter:	3-inch electro-dynamic tweeter
Dimensions:	17.75"l x 17.75"h x 14"w
Weight:	29 lbs.
Optional Accessories:	Black vinyl cover with silver embroidered logo Model #VC112-LM

Power Engine Hook-Up Diagrams (MONO)

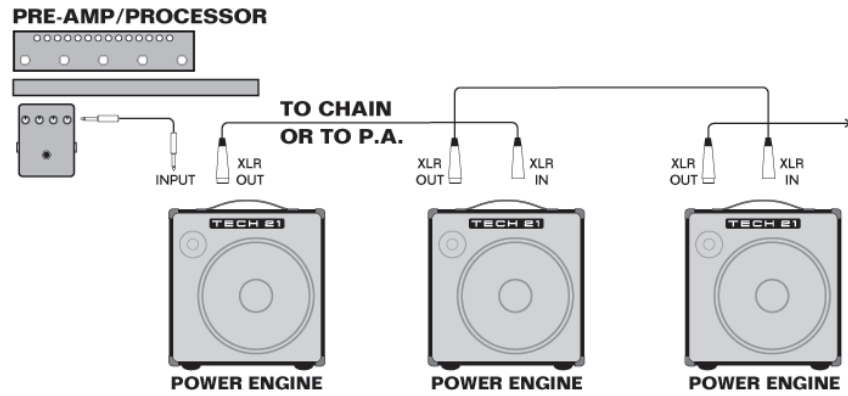
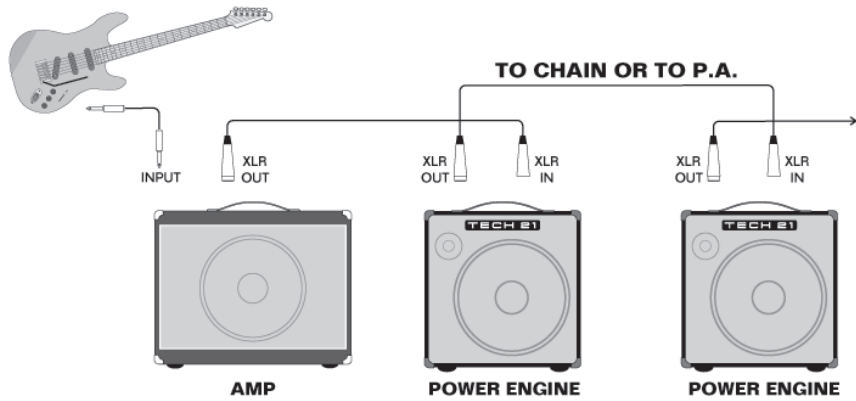

Power Engine Hook-Up Diagrams (STEREO)

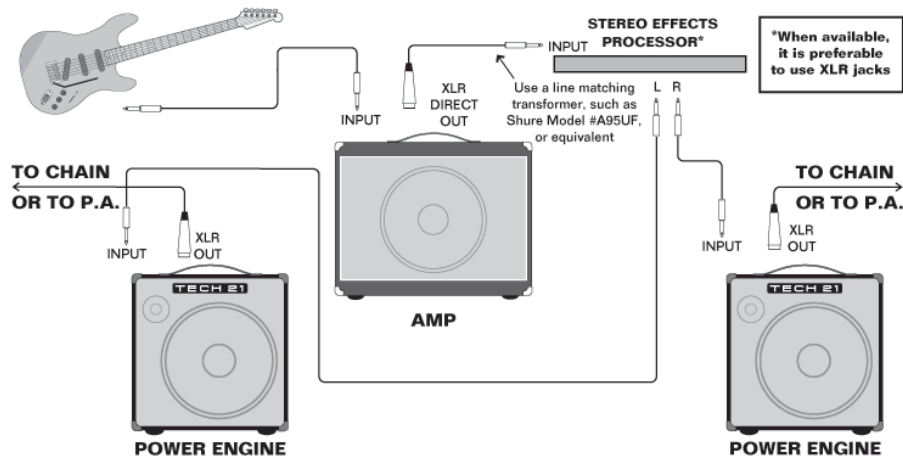

Power Engine Hook-Up Diagrams (STEREO)

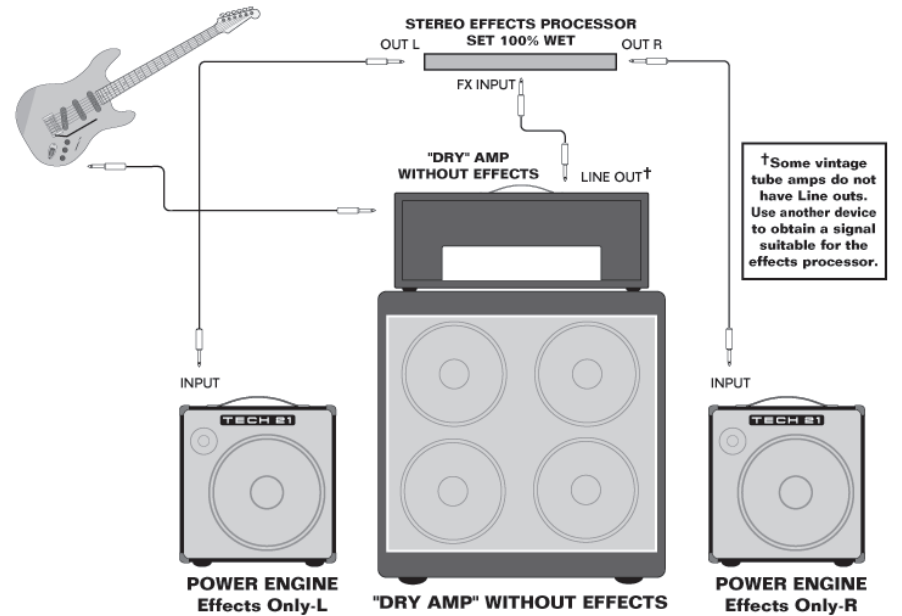
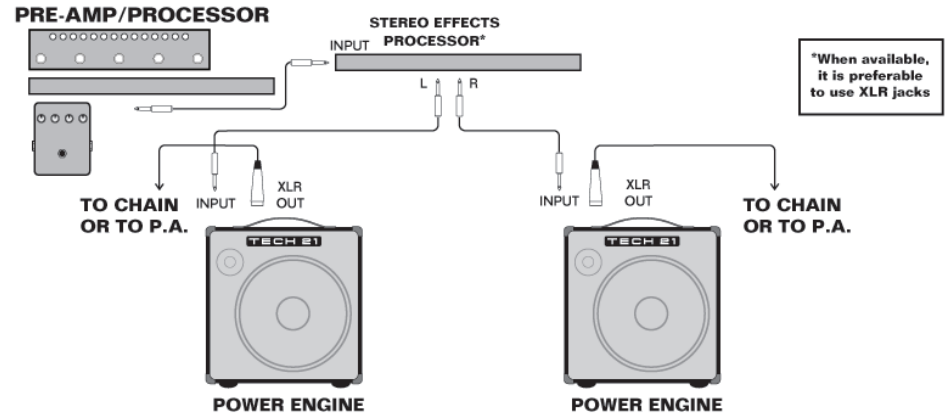

(MONO or STEREO)

